

User Manual of LED High Bay Light

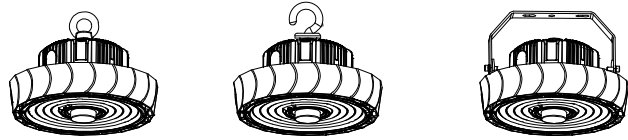

Product Introduction:

Welcome to buy our led high bay lights, using imported high-brightness SMD3030/2835 LED chips, unique high-purity die-casting aluminum ADC12 aluminum heat sink, high-efficiency constant current or constant voltage driver, is an ideal product for factories, stadiums, gas stations, trains Stations and similar applications.

Product Features:

- ☆ The material of the heat sink is high thermal conductivity die-cast aluminum ADC12, which has good heat dissipation, and the surface is anti-static and sprayed with outdoor powder.
- ☆ The unique design of housing help to speed up the heat dissipation, further ensuring the life of the fixture. The integrated design of appearance makes the fixture looks elegant.
- ☆ This fixture is waterproof, dustproof, anticorrosive

Technical Parameters:

Product/Parameter	G4HB M1	G4HB M2
LED	3030/2835	
Input Voltage	AC100-277/120-347/277-480V	
Power Frequency	50/60 Hz	
Material	aluminum	
reflector	Aluminum reflector60/90/120degree or PC reflector60/120degree	
Luminous efficiency	150lm/w	
Working Temperature	-40°~ +45°	
Storing Temperature	-40°~ +65°	
Working Humidity	15% ~ 90% RH	
Beam Angle	60°/90°/120°	
Waterproof level	IP65	
Warranty	5 years	
Color Temperature	30K/40K/50K selectable	
Net Weight	2.7KG±0.5	3.7KG±0.5
Gross Weight	4.0KG±0.5	5.5KG±0.5
Lamp Dimension	Ø252*H181mm	Ø320*H193mm
Package Size	L300*W300*H190mm	L370*W370*H200mm

Packing including:

- 1pc LED high bay light.
- 1pc product user manual.
- 1pc installation bracket or ring or hook.

the external flexible cable or cord of this luminaire cannot be replaced; if the cord is damaged, the luminaire shall be destroyed. (source:IEC 60417-6042 (2001-11)) ⚠

Warning:

1. Please read the manual carefully before installation.
2. Please authorize only qualified person or professional engineer to install the fixture.
3. Before installation, Please check if the local voltage range is correspond with the working voltage of the fixture.
4. If the fixture is damaged, it should be replaced by the supplier, a service agent or a qualified person.
5. please keep the fixture out of fire, electric shock, vibration.
6. To avoid fire, electric, shock.
7. Don't adjust the wattage and CCT if power is on, must adjust the switch after cut off AC power.

Slide Switch to adjust output power + Slide Switch to adjust color temperature

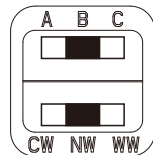

150W(A)-100W(B)-80W(C)

CW: White light
NW: Neutral light
WW: Warm light

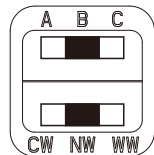

240W(A)-200W(B)-150W(C)

CW: White light
NW: Neutral light
WW: Warm light

Note: To adjust the output power and color temperature, you need to operate after AC OFF

Installation instruction:

Installation 1

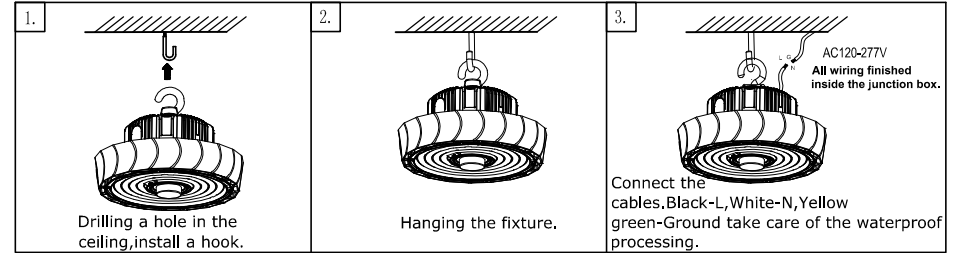

Installation 2

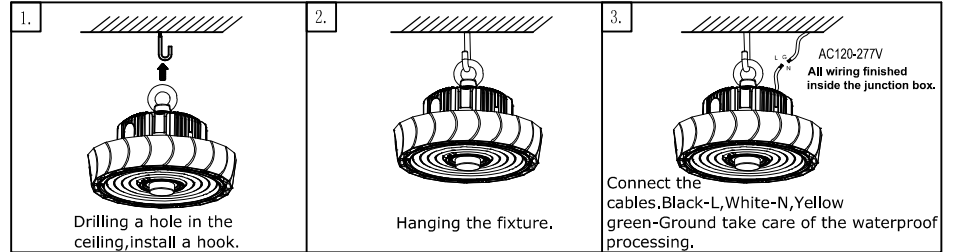

Installation 3

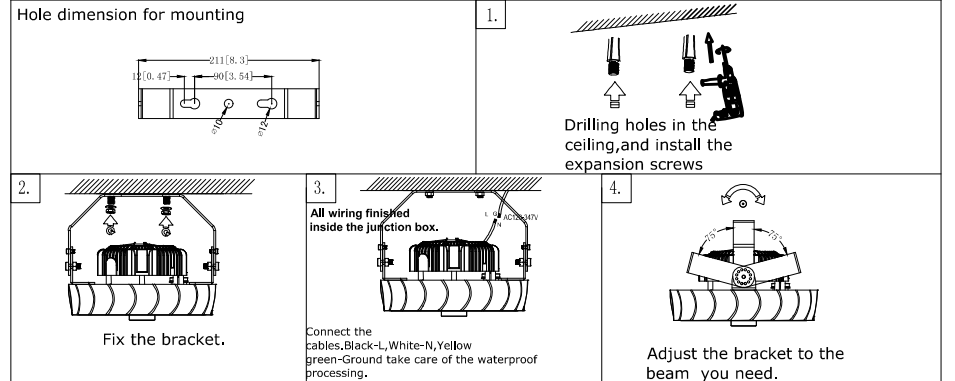

Reflector Installation

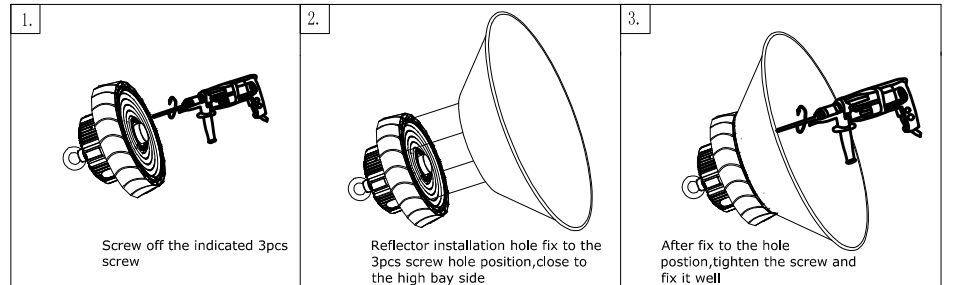

Wiring Diagram

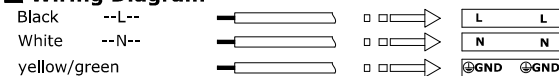

label

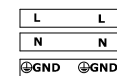

For type Z attachments: ⚠ the external flexible cable or cord of this luminaire cannot be replaced; if the cord is damaged, the luminaire shall be destroyed.