

Note:

- Risk of fire or electric shock, Please read and understand the detailed installation instructions before installing the LED T5 tube light.
- If the tube is installed as Type B, the luminaire, once modified as a retrofit fixture will no longer operate fluorescent lamps.
- Do not use where directly exposed to water or weather. Non-submergible (not water tight).
- Use in dry or damp locations only.
- Not suitable for use with dimmer.
- Disable all power to the fixture before inspection, installation, or removal. Failure to do so will create a hazardous and fatal working environment.
- Do not open – No user serviceable parts inside.

Type B Installation Guide:

1. DISCONNECT POWER TO LUMINAIRE

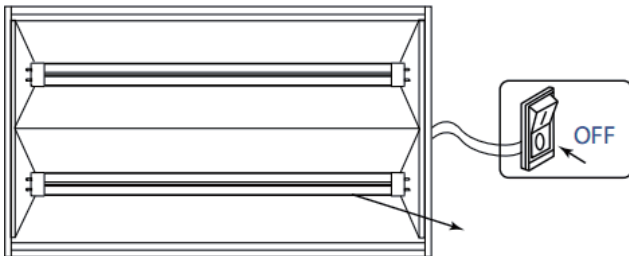

Fluorescent Tubes to be replaced.

Disconnect power to luminaire or circuit(if possible). Ensure all power is OFF by using a voltmeter or other approved method to confirm.

2. REMOVE EXISTING TUBE LAMP(S)

- a. Remove troffer lens, if present.
- b. Remove existing fluorescent tube by rotating one-quarter turn and sliding lamp(s)
- c. Remove ballast cover. (Cover may be secured with screws or tabs).

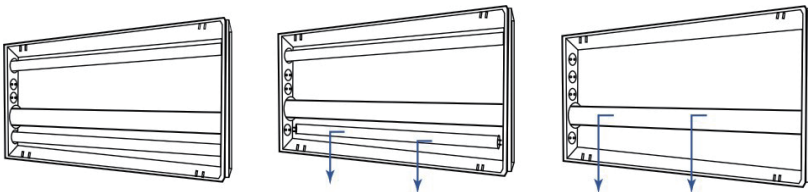

3. a. RETROFIT LUMINAIRE

Please rewiring the circuit according to the following circuit diagram

Case 1: Direct AC wiring diagram without dimming

Double-ended power input

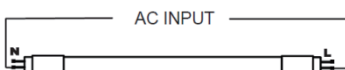

OR

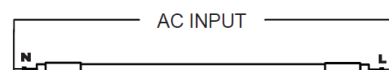

Voltage Input: AC120-277V 50/60Hz

Single-ended power input

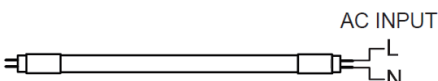

OR

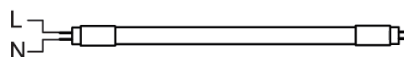

Voltage Input: AC120-277V 50/60Hz

Case 2: Direct AC wiring diagram with 0-10V dimming system

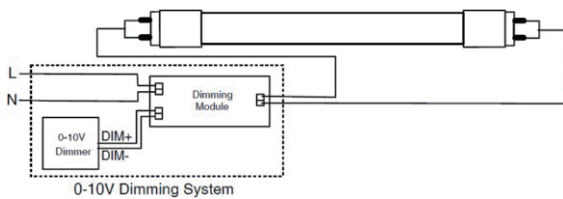

Voltage Input: AC120-277V 50/60Hz

4. INSERT LED TUBES

- a. Ensure both the ends of the LED tube are aligned with socket, then insert LED lamp in the normal way by sliding pins into sockets and rotating a quarter turn until the LED tube locks in place.
- b. LED lamps are now fully installed.
- c. Replace troffer lens, if present.
- d. After modification completed. Attach the replacement marking and cautionary label to a visible place on the luminaire and keep it visible after installation.

5. RESTORE THE POWER OF LUMINAIRE

Restore power to circuit/luminaire and test light. If necessary, adjust position of LED tube, and enjoy your new LED tube.